

# DEATH HOUSE

---



# CREDITS

**Lead Designer:** Christopher Perkins  
**Creative Consultants:** Tracy and Laura Hickman  
**Designers:** Adam Lee, Richard Whitters, Jeremy Crawford  
**Managing Editor:** Jeremy Crawford  
**Editor:** Kim Mohan  
**Editorial Assistance:** Scott Fitzgerald Gray  
**D&D Lead Designers:** Mike Mearls, Jeremy Crawford

**Art Director:** Kate Irwin  
**Additional Art Direction:** Shauna Narciso, Richard Whitters  
**Graphic Designer:** Emi Tanji  
**Cover Illustrator:** Ben Oliver  
**Interior Illustrators:** Dave Allsop, François Beauregard, Mark Behm, Eric Belisle, Zoltan Boros, Jedd Chevrier, Daarken, Lake Hurwitz, Chuck Lukacs, Howard Lyon, Ben Oliver, Adam Paquette, Rob Rey, Chris Seaman, Richard Whitters, Kieran Yanner  
**Cartographers:** François Beauregard, Mike Schley, Ben Wooten

**Project Managers:** Neil Shinkle, Heather Fleming  
**Product Engineer:** Cynda Callaway  
**Imaging Technicians:** Sven Bolen, Carmen Cheung, Kevin Yee  
**Prepress Specialist:** Jefferson Dunlap

**Other D&D Team Members:** Greg Bilsland, Chris Dupuis, David Gershman, John Feil, Trevor Kidd, Christopher Lindsay, Shelly Mazzanoble, Ben Petrisor, Hilary Ross, Liz Schuh, Matt Sernett, Nathan Stewart, Greg Tito

DUNGEONS & DRAGONS, D&D, Wizards of the Coast, Forgotten Realms, Ravenloft, the dragon ampersand, *Player's Handbook*, *Monster Manual*, *Dungeon Master's Guide*, all other Wizards of the Coast product names, and their respective logos are trademarks of Wizards of the Coast in the USA and other countries. All characters and their distinctive likenesses are property of Wizards of the Coast. This material is protected under the copyright laws of the United States of America. Any reproduction or unauthorized use of the material or artwork contained herein is prohibited without the express written permission of Wizards of the Coast.

Printed in the USA. ©2016 Wizards of the Coast LLC, PO Box 707, Renton, WA 98057-0707, USA. Manufactured by Hasbro SA, Rue Emile-Boéchat 31, 2800 Delémont, CH.  
Represented by Hasbro Europe, 4 The Square, Stockley Park, Uxbridge, Middlesex, UB11 1ET, UK.

# DEATH HOUSE

You can run *Curse of Strahd* for 1st-level characters with the help of this optional mini-adventure, which is designed to advance characters to 3rd level. Players creating 1st-level characters can use the haunted one character background in appendix A, or they can pick backgrounds from the *Player's Handbook* as normal.

Before the characters can explore the haunted townhouse known as Death House, you need to guide them to the village of Barovia. The “Creeping Fog” adventure hook in chapter 1 works best, as it introduces few distractions. Once the characters arrive in Strahd’s domain, steer them to the village. For the duration of this introductory adventure, any attempt by the characters to explore other locations in Strahd’s domain causes the mists of Ravenloft to block their path.

## LEVEL ADVANCEMENT

In this mini-adventure, the characters gain levels by accomplishing specific goals, rather than by slaying monsters. These milestones are as follows:

- Characters who gain access to the secret stairs in the attic (area 21) advance to 2nd level. The stairs appear only under certain circumstances.
- Characters advance to 3rd level once they escape from the house (see the “Endings” section).

## HISTORY

Death House is the name given to an old row house in the village of Barovia (area E7 on the village map). The house has been burned to the ground many times, only to rise from the ashes time and again—by its own will or that of Strahd. Locals give the building a wide berth for fear of antagonizing the evil spirits believed to haunt it.

The wealthy family that built the house practiced the dark arts. Through seduction and indoctrination, they expanded their cult to include a small yet nefarious circle of friends. When word got out, the rest of the village turned a blind eye to the house and the nightly debaucheries happening within it.

The cult tried to summon malevolent extraplanar entities with no success. The cultists also preyed on visitors, sacrificed them in bizarre rituals, and hosted morbid banquets to feast on their corpses. When nothing came of these ritualized murders, the cultists’ activities became thinly disguised excuses to indulge their lurid fantasies. The ranks of the cult thinned as members began to lose interest in the debacle.

Then Strahd von Zarovich arrived.

The cultists regarded Strahd as a messiah sent to them by the Dark Powers. Drawn to Strahd like moths to a flame, they pledged their devotion for a promise of immortality, but Strahd turned them away, deeming the cult and its leaders unworthy of his attention. The cultists withdrew to Death House in despair.

The cult’s habit of trapping and devouring wayward visitors proved to be its downfall. On one occasion, the cult snared a band of adventurers whom Strahd had lured to his domain to be his playthings. A black car-

riage arrived at Death House soon thereafter, and from out of its black heart stepped the vampire himself. The cultists tried to impress Strahd. In response, he slaughtered them for slaying his playthings. Centuries later, the cultists’ spirits haunt the dungeons under the house. The building itself, it seems, is unwilling to let the cult be forgotten.

## ROSE AND THORN

The characters are pulled into Strahd’s domain by the mists of Ravenloft. Forced to follow a lonely road (area A), they eventually arrive at the village of Barovia (area E). Once they reach the village, read:

The gravel road leads to a village, its tall houses dark as tombstones. Nestled among these solemn dwellings are a handful of closed-up shops. Even the tavern is shut tight.

A soft whimpering draws your eye toward a pair of children standing in the middle of an otherwise lifeless street.

The children are ten-year-old Rosavalda (“Rose”) and her seven-year-old brother, Thornboldt (“Thorn”). Thorn is weeping and clutching a stuffed doll. Rose is trying to hush the boy.

If the characters approach the children or call out to them, add the following:

After shushing the boy, the girl turns to you and says, “There’s a monster in our house!” She then points to a tall brick row house that has seen better days. Its windows are dark. It has a gated portico on the ground floor, and the rusty gate is slightly ajar. The houses on either side are abandoned, their windows and doors boarded up.

Characters who question the children learn the following information:

- The children don’t know what the “monster” looks like, but they’ve heard its terrible howls.
- Their parents (Gustav and Elisabeth Durst) keep the monster trapped in the basement.
- There’s a baby (Walter) in the third-floor nursery. (Untrue, but the children believe it.)

Rose and Thorn say that they won’t go back in the house until they know the monster is gone. They can be convinced to wait in the portico (area 1A) while the characters search the house. Although they appear to be flesh-and-blood children, Rose and Thorn are actually illusions created by the house to lure the characters inside. The children don’t know that they’re illusions but vanish if attacked or forced into the house.

The children died of starvation centuries ago after their insane parents locked them in the attic and forgot about them. They were too young and innocent to understand that their parents were guilty of heinous crimes. Their parents told them stories about a monster in the basement to keep the children from going down to the dungeon level. The “terrible howls” they heard were actually the screams of the cult’s victims.



## THE MISTS

Characters who remain outside the house can see the mists close in around them, swallowing up the rest of the village. As more buildings disappear into the mists, the characters are left with little choice but to seek refuge in the house. The mists stop short of entering the house but engulf anyone outside (see chapter 2, “The Lands of Barovia,” for information on the mists’ effect).

## AREAS OF THE HOUSE

The following areas correspond to labels on the map of the house on page 216.

### 1. ENTRANCE

A wrought-iron gate with hinges on one side and a lock on the other fills the archway of a stone portico (area 1A). The gate is unlocked, and its rusty hinges shriek when the gate is opened. Oil lamps hang from the portico ceiling by chains, flanking a set of oaken doors that open into a grand foyer (area 1B).

Hanging on the south wall of the foyer is a shield emblazoned with a coat-of-arms (a stylized golden

### DEATH HOUSE’S FEATURES

Death House is aware of its surroundings and all creatures within it. Its goal is to continue the work of the cult by luring visitors to their doom. Various important features of the house are summarized here.

The house has four stories (including the attic), with two balconies on the third floor—one facing the front of the house, the other facing the back. The house has wooden floors throughout, and all windows have hinges that allow them to swing outward.

The rooms on the first and second floors are free of dust and signs of age. The floorboards and wall panels are well oiled, the drapes and wallpaper haven’t faded, and the furniture looks new. No effort has been made to preserve the contents of the third floor or the attic. These areas are dusty and drafty, everything within them is old and draped in cobwebs, and the floorboards groan underfoot.

Ceilings vary in height by floor. The first floor has 10-foot-high ceilings, the second floor has 12-foot-high ceilings, the third floor has 8-foot-high ceilings, and the attic has 13-foot-high ceilings.

None of the rooms in the house are lit when the characters arrive, although most areas contain working oil lamps or fireplaces.

Characters can burn the house to the ground if they want, but any destruction to the house is temporary. After 1d10 days, the house begins to repair itself. Ashes sweep together to form blackened timbers, which then turn back into a sturdy wooden frame around which walls begin to materialize. Destroyed furnishings are likewise repaired. It takes 2d6 hours for the house to complete its resurrection. Items taken from the house aren’t replaced, nor are undead that are destroyed. The dungeon level isn’t considered part of the house and can’t repair itself in this fashion.

windmill on a red field), flanked by framed portraits of stony-faced aristocrats (long-dead members of the Durst family). Mahogany-framed double doors leading from the foyer to the main hall (area 2A) are set with panes of stained glass.

### 2. MAIN HALL

A wide hall (area 2A) runs the width of the house, with a black marble fireplace at one end and a sweeping, red marble staircase at the other. Mounted on the wall above the fireplace is a longsword (nonmagical) with a windmill cameo worked into the hilt. The wood-paneled walls are ornately sculpted with images of vines, flowers, nymphs, and satyrs. Characters who search the walls for secret doors or otherwise inspect the paneling can, with a successful DC 12 Wisdom (Perception) check, see serpents and skulls inconspicuously woven into the wall designs. The decorative paneling follows the staircase as it circles upward to the second floor.

A cloakroom (area 2B) has several black cloaks hanging from hooks on the walls. A top hat sits on a high shelf.

### 3. DEN OF WOLVES

This oak-paneled room looks like a hunter’s den. Mounted above the fireplace is a stag’s head, and positioned around the outskirts of the room are three stuffed wolves.

Two padded chairs draped in animal furs face the hearth, with an oak table between them supporting a cask of wine, two carved wooden goblets, a pipe rack, and a candelabrum. A chandelier hangs above a cloth-covered table surrounded by four chairs.

Two cabinets stand against the walls. The east cabinet sports a lock that can be picked with thieves' tools and a successful DC 15 Dexterity check. It holds a heavy crossbow, a light crossbow, a hand crossbow, and 20 bolts for each weapon. The north cabinet is unlocked and holds a small box containing a deck of playing cards and an assortment of wine glasses.

#### TRAPDOOR

A trapdoor is hidden in the southwest corner of the floor. It can't be detected or opened until the characters approach it from the underside (see area 32). Until then, Death House supernaturally hides the trapdoor.

### 4. KITCHEN AND PANTRY

The kitchen (area 4A) is tidy, with dishware, cookware, and utensils neatly placed on shelves. A worktable has a cutting board and rolling pin atop it. A stone, dome-shaped oven stands near the east wall, its bent iron stovepipe connecting to a hole in the ceiling. Behind the stove and to the left is a thin door leading to a well-stocked pantry (area 4B). All the food in the pantry appears fresh but tastes bland.

#### DUMBWAITER

Behind a small door in the southwest corner of the kitchen is a dumbwaiter—a 2-foot-wide stone shaft containing a wooden elevator box attached to a simple rope-and-pulley mechanism that must be operated manually. The shaft connects to areas 7A (the servants' quarters) and 12A (the master bedroom). Hanging on the wall next to the dumbwaiter is a tiny brass bell attached by wires to buttons in those other areas.

A Small character can squeeze into the elevator box with a successful DC 10 Dexterity (Acrobatics) check. The dumbwaiter's rope-and-pulley mechanism can support 200 pounds of weight before breaking.

### 5. DINING ROOM

The centerpiece of this wood-paneled dining room is a carved mahogany table surrounded by eight high-backed chairs with sculpted armrests and cushioned seats. A crystal chandelier hangs above the table, which is covered with resplendent silverware and crystalware polished to a dazzling shine. Mounted above the marble fireplace is a mahogany-framed painting of an alpine vale.

The wall paneling is carved with elegant images of deer among the trees. Characters who search the walls for secret doors or otherwise inspect the paneling can, with a successful DC 12 Wisdom (Perception) check, see twisted faces carved into the tree trunks and wolves lurking amid the carved foliage.

Red silk drapes cover the windows, and a tapestry depicting hunting dogs and horse-mounted aristocrats chasing after a wolf hangs from an iron rod bolted to the south wall.

The silverware tarnishes, the crystal cracks, the portrait fades, and the tapestry rots if removed from the house.

### 6. UPPER HALL

Unlit oil lamps are mounted on the walls of this elegant hall. Hanging above the mantelpiece is a wood-framed portrait of the Durst family: Gustav and Elisabeth Durst with their two smiling children, Rose and Thorn. Cradled in the father's arms is a swaddled baby, which the mother regards with a hint of scorn.

Standing suits of armor flank wooden doors in the east and west walls. Each suit of armor clutches a spear and has a visored helm shaped like a wolf's head. The doors are carved with dancing youths, although close inspection and a successful DC 12 Wisdom (Perception) check reveals that the youths aren't really dancing but fighting off swarms of bats.

The red marble staircase that started on the first floor continues its upward spiral to area 11. A cold draft can be felt coming down the steps.

### 7. SERVANTS' ROOM

An undecorated bedroom (area 7A) contains a pair of beds with straw-stuffed mattresses. At the foot of each bed is an empty footlocker. Tidy servants' uniforms hang from hooks in the adjoining closet (area 7B).

#### DUMBWAITER

A dumbwaiter in the corner of the west wall has a button on the wall next to it. Pressing the button rings the tiny bell in area 4A.

### 8. LIBRARY

The master of the house used to spend many hours here before his descent into madness.

Red velvet drapes cover the windows of this room. An exquisite mahogany desk and a matching high-back chair face the entrance and the fireplace, above which hangs a framed picture of a windmill perched atop a rocky crag. Situated in corners of the room are two overstuffed chairs. Floor-to-ceiling bookshelves line the south wall. A rolling wooden ladder allows one to more easily reach the high shelves.

The desk has several items resting atop it: an oil lamp, a jar of ink, a quill pen, a tinderbox, and a letter kit containing a red wax candle, four blank sheets of parchment, and a wooden seal bearing the Durst family's insignia (a windmill). The desk drawer is empty except for an iron key, which unlocks the door to area 20.

The bookshelves hold hundreds of tomes covering a range of topics including history, warfare, and alchemy. There are also several shelves containing first-edition collected works of poetry and fiction. The books rot and fall apart if taken from the house.

### SECRET DOOR

A secret door behind one bookshelf can be unlocked and swung open by pulling on a switch disguised to look like a red-covered book with a blank spine. A character inspecting the bookshelf spots the fake book with a successful DC 13 Wisdom (Perception) check. Unless the secret door is propped open, springs in the hinges cause it to close on its own. Beyond the secret door lies area 9.

## 9. SECRET ROOM

This secret room contains bookshelves packed with tomes describing fiend-summoning rituals and the necromantic rituals of a cult called the Priests of Osybus. The rituals are bogus, which any character can ascertain after studying the books for 1 hour and succeeding on a DC 12 Intelligence (Arcana) check.

A heavy wooden chest with clawed iron feet stands against the south wall, its lid half-closed. Sticking out of the chest is a skeleton in leather armor. Close inspection reveals that the skeleton belongs to a human who triggered a poisoned dart trap. Three darts are stuck in the dead adventurer's armor and ribcage. The dart-firing mechanism inside the chest no longer functions.

Clutched in the skeleton's left hand is a letter bearing the seal of Strahd von Zarovich, which the adventurer tried to remove from the chest. Written in flowing script, the letter reads as follows:

*My most pathetic servant,*

*I am not a messiah sent to you by the Dark Powers of this land. I have not come to lead you on a path to immortality. However many souls you have bled on your hidden altar, however many visitors you have tortured in your dungeon, know that you are not the ones who brought me to this beautiful land. You are but worms writhing in my earth.*

*You say that you are cursed, your fortunes spent. You abandoned love for madness, took solace in the bosom of another woman, and sired a stillborn son. Cursed by darkness? Of that I have no doubt. Save you from your wretchedness? I think not. I much prefer you as you are.*

*Your dread lord and master,  
Strahd von Zarovich*

### TREASURE

The chest contains three blank books with black leather covers (worth 25 gp each), three spell scrolls (*bless*, *protection from poison*, and *spiritual weapon*), the deed to the house, the deed to a windmill, and a signed will. The windmill referred to in the second deed is situated in the mountains east of Vallaki (see chapter 6, "Old Bonegrinder"). The will is signed by Gustav and Elisabeth Durst and bequeathes the house, the windmill, and all other family property to Rosavalda and Thornboldt Durst in the event of their parents' deaths. The books, scrolls, deeds, and will age markedly if taken from the house but remain intact.

## 10. CONSERVATORY

Gossamer drapes cover the windows of this elegantly appointed hall, which has a brass-plated chandelier

hanging from the ceiling. Upholstered chairs line the walls, and stained-glass wall hangings depict beautiful men, women, and children singing and playing instruments.

A harpsichord with a bench rests in the northwest corner. Near the fireplace is a large standing harp. Alabaster figurines of well-dressed dancers adorn the mantelpiece. Close inspection of them reveals that several are carvings of well-dressed skeletons.

## 11. BALCONY

Characters who climb the red marble staircase to its full height come to a dusty balcony with a suit of black plate armor standing against one wall, draped in cobwebs. This suit of **animated armor** attacks as soon as it takes damage or a character approaches within 5 feet of it. It fights until destroyed.

Oil lamps are mounted on the oak-paneled walls, which are carved with woodland scenes of trees, falling leaves, and tiny critters. Characters who search the walls for secret doors or otherwise inspect the paneling can, with a successful DC 12 Wisdom (Perception) check, notice tiny corpses hanging from the trees and worms bursting up from the ground.

### SECRET DOOR

A secret door in the west wall can be found with a successful DC 15 Wisdom (Perception) check. It pushes open easily to reveal a cobweb-filled wooden staircase leading up to the attic.

## 12. MASTER SUITE

The double doors to this room have dusty panes of stained glass set into them. Designs in the glass resemble windmills.

The dusty, cobweb-filled master bedroom (area 12A) has burgundy drapes covering the windows. Furnishings include a four-poster bed with embroidered curtains and tattered gossamer veils, a matching pair of empty wardrobes, a vanity with a wood-framed mirror and jewelry box (see "Treasure"), and a padded chair. A rotting tiger-skin rug lies on the floor in front of the fireplace, which has a dust-covered portrait of Gustav and Elisabeth Durst hanging above it. A web-filled parlor in the southwest corner contains a table and two chairs. Resting on the dusty tablecloth is an empty porcelain bowl and a matching jug.

A door facing the foot of the bed has a full-length mirror mounted on it. The door opens to reveal an empty, dust-choked closet (area 12B). A door in the parlor leads to an outside balcony (area 12C).

### DUMBWAITER

A dumbwaiter in the corner of the west wall has a button on the wall next to it. Pressing the button rings the tiny bell in area 4A.

### TREASURE

The jewelry box on the vanity is made of silver with gold filigree (worth 75 gp). It contains three gold rings (worth 25 gp each) and a thin platinum necklace with a topaz pendant (worth 750 gp).

### 13. BATHROOM

This dark room contains a wooden tub with clawed feet, a small iron stove with a kettle resting atop it, and a barrel under a spigot in the east wall. A cistern on the roof used to collect rainwater, which was borne down a pipe to the spigot; however, the plumbing no longer works.

### 14. STORAGE ROOM

Dusty shelves line the walls of this room. A few of the shelves have folded sheets, blankets, and old bars of soap on them. A cobweb-covered **broom of animated attack** (see appendix D) leans against the far wall; it attacks any creature approaching within 5 feet of it.

### 15. NURSEMAID'S SUITE

Dust and cobwebs shroud an elegantly appointed bedroom (area 15A) and an adjoining nursery (area 15B). Double doors set with panes of stained glass pull open to reveal a balcony (area 15C) overlooking the front of the house.

The bedroom once belonged to the family's nursemaid. The master of the house and the nursemaid had an affair, which led to the birth of a stillborn baby named Walter. The cult slew the nursemaid shortly thereafter. Unless the characters already defeated it in area 18, the nursemaid's spirit haunts the bedroom as a **specter**. The specter manifests and attacks when a character opens the door to the nursery. The specter resembles a terrified, skeletally thin young woman; it can't speak or be reasoned with.

The bedroom contains a large bed, two end tables, and an empty wardrobe. Mounted on the wall next to the wardrobe is a full-length mirror with an ornate wooden frame carved to look like ivy and berries. Characters who search the wall for secret doors or otherwise inspect the mirror can, with a successful DC 12 Wisdom (Perception) check, notice eyeballs among the berries. The wall behind the mirror has a secret door in it (see "Secret Door" below).

The nursery contains a crib covered with a hanging black shroud. When characters part the shroud, they see a tightly wrapped, baby-sized bundle lying in the crib. Characters who unwrap the blanket find nothing inside it.

#### SECRET DOOR

A secret door behind the mirror can be found with a successful DC 15 Wisdom (Perception) check. It pushes open easily to reveal a cobweb-filled wooden staircase leading up to the attic.

### 16. ATTIC HALL

This bare hall is choked with dust and cobwebs.

#### LOCKED DOOR

The door to area 20 is held shut with a padlock. Its key is kept in the library (area 8), but the lock can also be picked with thieves' tools and a successful DC 15 Dexterity check.

### 17. SPARE BEDROOM

This dust-choked room contains a slender bed, a nightstand, a small iron stove, a writing desk with a stool, an empty wardrobe, and a rocking chair. A smiling doll in a lacy yellow dress sits in the northern window box, cobwebs draping it like a wedding veil.

### 18. STORAGE ROOM

This dusty chamber is packed with old furniture (chairs, coat racks, standing mirrors, dress mannequins, and the like), all draped in dusty white sheets. Near an iron stove, underneath one of the sheets, is an unlocked wooden trunk containing the skeletal remains of the family's nursemaid, wrapped in a tattered bedsheet stained with dry blood. A character inspecting the remains and succeeding on a DC 14 Wisdom (Medicine) check can verify that the woman was stabbed to death by multiple knife wounds.

If the characters disturb the remains, the nursemaid's **specter** appears and attacks unless it was previously defeated in area 15.

#### SECRET DOOR

A secret door in the east wall appears only when certain conditions are met; see area 21 for more information.

### 19. SPARE BEDROOM

This web-filled room contains a slender bed, a nightstand, a rocking chair, an empty wardrobe, and a small iron stove.

### 20. CHILDREN'S ROOM

The door to this room is locked from the outside (see area 16 for details).

This room contains a bricked-up window flanked by two dusty, wood-framed beds sized for children. Closer to the door is a toy chest with windmills painted on its sides and a dollhouse that's a perfect replica of the dreary edifice in which you stand. These furnishings are draped in cobwebs. Lying in the middle of the floor are two small skeletons wearing tattered but familiar clothing. The smaller of the two cradles a stuffed doll that you also recognize.

The Durst children, Rose and Thorn, were neglected by their parents and locked in this room until they starved to death. Their small skeletons lie in the middle of the floor, plain as day, wearing tattered clothing that the characters recognize as belonging to the children. Thorn's skeleton cradles the boy's stuffed doll.

The toy chest contains an assortment of stuffed animals and toys. Characters who search the dollhouse and succeed on a DC 15 Wisdom (Perception) check find all of the house's secret doors, including one in the attic that leads to a spiral staircase (a miniature replica of area 21).



Front View



# Death House

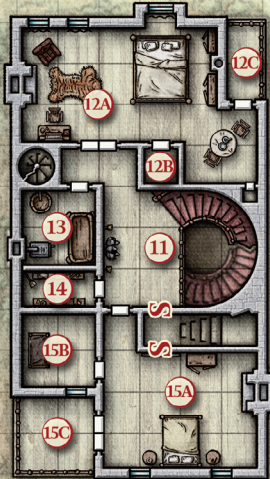
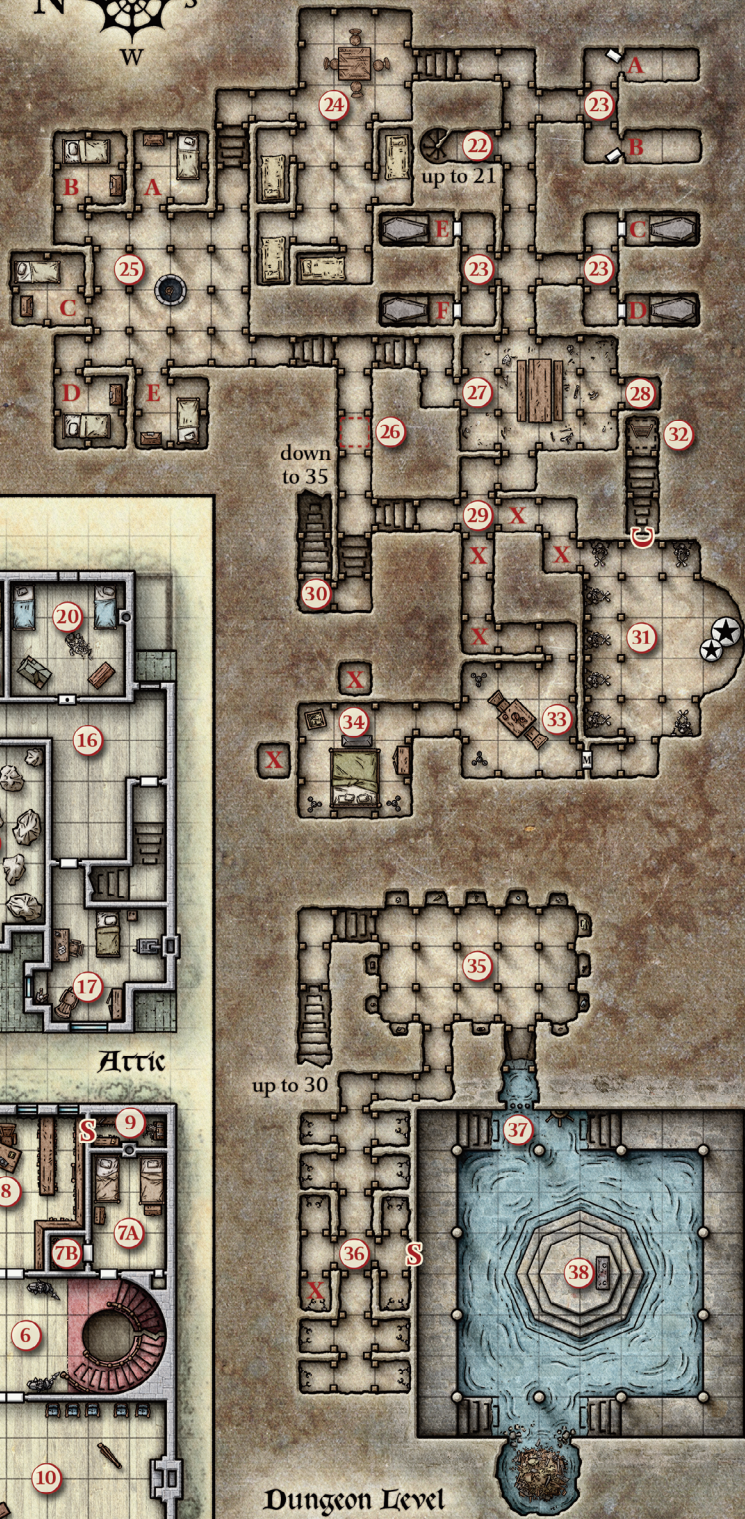

Third Floor



Attic



First Floor



Second Floor

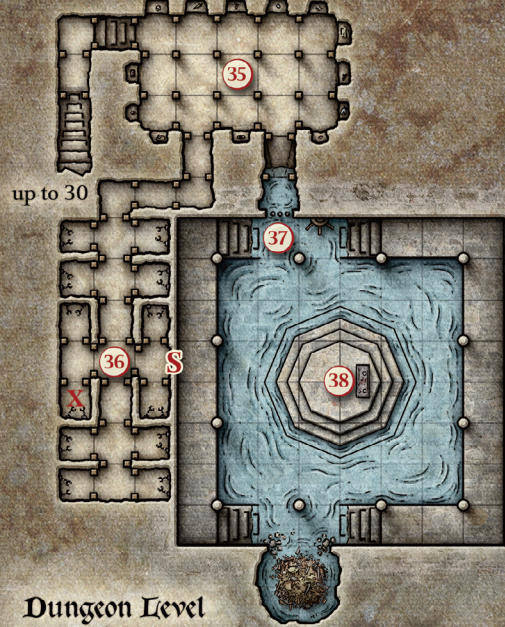

Dungeon Level

One square = 5 feet



## ROSE AND THORN

If either the dollhouse or the chest is disturbed, the ghosts of Rose and Thorn appear in the middle of the room. Use the **ghost** statistics in the *Monster Manual*, with the following modifications:

- The ghosts are Small and lawful good.
- They have 35 (10d6) hit points each.
- They lack the Horrifying Visage action.
- They speak Common and have a challenge rating of 3 (700 XP).

The children don't like it when the characters disturb their toys, but they fight only in self-defense. Unlike the illusions outside the house, these children know that they're dead. If asked how they died, Rose and Thorn explain that their parents locked them in the attic to protect them from "the monster in the basement," and that they died from hunger. If asked how one gets to the basement, Rose points to the dollhouse and says, "There's a secret door in the attic." Characters who then search the dollhouse for secret doors gain advantage on their Wisdom (Perception) checks to find them.

The children fear abandonment. If one or more characters try to leave, the ghost-children attempt to possess them. If one of the ghosts possesses a character, allow the player to retain control of the character, but assign the character one of the following flaws:

- A character possessed by Rose gains the following flaw: "I like being in charge and get angry when other people tell me what to do."
- A character possessed by Thorn gains the following flaw: "I'm scared of everything, including my own shadow, and weep with despair when things don't go my way."

A character possessed by the ghost of Rose or Thorn won't willingly leave Death House or the dungeon below it. Both ghosts can be intimidated into leaving their hosts with a successful DC 11 Charisma (Intimidation) check made as an action.

A ghost reduced to 0 hit points can reform at dawn the next day. The only way to put the children's spirits to rest is to put their skeletal remains in their tombs (areas 23E and 23F). The children don't know this, however.

## DEVELOPMENT

If the party lays the children's spirits to rest, each character gains inspiration (see "Inspiration" in chapter 4, "Personality and Background," of the *Player's Handbook*).

## 21. SECRET STAIRS

A narrow spiral staircase made of creaky wood is contained within a 5-foot-wide shaft of mortared stone that starts in the attic and descends 50 feet to the dungeon level, passing through the lower levels of the house as it makes its descent. Thick cobwebs fill the shaft and reduce visibility in the staircase to 5 feet.

The secret door and shaft don't exist until the house reveals them, which can happen in one of two ways:

- The characters find Strahd's letter in the secret room behind the library (area 9).

## DUNGEON FEATURES

The dungeon level underneath Death House is carved out of earth, clay, and rock. The tunnels are 4 feet wide by 7 feet high with timber braces at 5-foot intervals. Rooms are 8 feet tall and supported by thick wooden posts with crossbeams. The only exception is area 38, which has a 16-foot-high ceiling supported by stone pillars. Characters without darkvision must provide their own light sources, as the dungeon is unlit.

As the characters explore the dungeon, they see centuries-old human footprints in the earthen floor leading every which way.

- The characters find the replica secret door in the attic of the dollhouse (area 20).

Once the house wills the secret door into existence, characters find it automatically if they search the wall (no ability check required). Characters who descend the spiral staircase end up in area 22.

## 22. DUNGEON LEVEL ACCESS

The wooden spiral staircase from the attic ends here. A narrow tunnel stretches southward before branching east and west.

### GHOSTLY CHANTING

From the moment they arrive in the dungeon, the characters can hear an eerie, incessant chant echoing throughout. It's impossible to gauge where the sound is coming from until the characters reach area 26 or 29. They can't discern its words until they reach area 35.

## 23. FAMILY CRYPTS

Several crypts have been hewn from the earth. Each crypt is sealed with a stone slab unless noted otherwise. Removing a slab from its fitting requires a successful DC 15 Strength (Athletics) check; using a crowbar or the like grants advantage on the check.

### 23A. EMPTY CRYPT

The blank stone slab meant to seal this crypt leans against a nearby wall. The crypt is empty.

### 23B. WALTER'S CRYPT

The stone slab meant to seal this crypt leans against a nearby wall. Etched into it is the name Walter Durst. The crypt is empty.

### 23C. GUSTAV'S CRYPT

The stone slab is etched with the name Gustav Durst. The chamber beyond contains an empty coffin atop a stone bier.

### 23D. ELISABETH'S CRYPT

The stone slab is etched with the name Elisabeth Durst. The crypt contains a stone bier with an empty coffin atop it. A **swarm of insects** (centipedes) boils out of the back wall and attacks if the coffin is disturbed.

### 23E. ROSE'S CRYPT

The stone slab is etched with the name Rosavalda Durst. The chamber beyond contains an empty coffin on a stone bier.

If Rose's skeletal remains (see area 20) are placed in the coffin, the child's ghost finds peace and disappears forever. A character possessed by Rose's ghost when this occurs is no longer possessed (see also the "Development" section in area 20).

### 23F. THORN'S CRYPT

The stone slab is etched with the name Thornboldt Durst. The chamber beyond contains an empty coffin on a stone bier.

If Thorn's skeletal remains (see area 20) are placed in the coffin, the child's ghost finds peace and disappears forever. A character possessed by Thorn's ghost when this occurs is no longer possessed (see also the "Development" section in area 20).

## 24. CULT INITIATES' QUARTERS

A wooden table and four chairs stand at the east end of this room. To the west are four alcoves containing moldy straw pallets.

## 25. WELL AND CULTIST QUARTERS

A 4-foot-diameter well shaft with a 3-foot-high stone lip descends 30 feet to a water-filled cistern. A wooden bucket hangs from a rope-and-pulley mechanism bolted to the crossbeams above the well.

Five side rooms once served as quarters for senior cultists. Each contains a wood-framed bed with a moldy straw mattress and a wooden chest to hold personal belongings. Each chest is secured with a rusty iron padlock that can be picked with thieves' tools and a successful DC 15 Dexterity check.

### TREASURE

In addition to some worthless personal effects, each chest contains one or more valuable items.

- 25A.** This room's chest contains 11 gp and 60 sp in a pouch made of human skin.
- 25B.** This room's chest contains three moss agates (worth 10 gp each) in a folded piece of black cloth.
- 25C.** This room's chest contains a black leather eyepatch with a carnelian (worth 50 gp) sewn into it.
- 25D.** This room's chest contains an ivory hairbrush with silver bristles (worth 25 gp).
- 25E.** This room's chest contains a silvered shortsword (worth 110 gp).

## 26. HIDDEN SPIKED PIT

The ghostly chanting heard throughout the dungeon gets discernibly louder as one heads west along this tunnel. A successful DC 15 Wisdom (Perception) check reveals an absence of footprints. Characters searching the floor for traps find a 5-foot-long, 10-foot-deep pit hidden under several rotted wooden planks, all hidden under a thin layer of dirt. The pit has sharpened wooden spikes at the bottom. The first character to step on the cover falls through, landing prone and taking 3 (1d6) bludgeoning damage from the fall plus 11 (2d10) piercing damage from the spikes.

## 27. DINING HALL

This room contains a plain wooden table flanked by long benches. Moldy humanoid bones lie strewn on the dirt floor—the remains of the cult's vile banquets.

In the middle of the south wall is a darkened alcove (area 28). Characters who approach within 5 feet of the alcove provoke the creature that lurks there.

## 28. LARDER

This alcove contains a **grick** that slithers out to attack the first character it sees within 5 feet of it. Any character with a passive Wisdom (Perception) score under 12 is surprised by it. The alcove is otherwise empty.

## 29. GHOULISH ENCOUNTER

The ghostly chanting heard throughout the dungeon is noticeably louder to the north. When one or more characters reach the midpoint of the four-way tunnel intersection, four **ghouls** (former cultists) rise up out of the ground in the spaces marked X on the map and attack. The ghouls fight until destroyed.

## 30. STAIRS DOWN

It's obvious to any character standing at the top of this 20-foot-long staircase that the ghostly chants originate from somewhere below. Characters who descend the stairs and follow the hall beyond arrive in area 35.

## 31. DARKLORD'S SHRINE

This room is festooned with moldy skeletons that hang from rusty shackles against the walls. A wide alcove in the south wall contains a painted wooden statue carved in the likeness of a gaunt, pale-faced man wearing a voluminous black cloak, his pale left hand resting on the head of a wolf that stands next to him. In his right hand, he holds a smoky-gray crystal orb.

The room has exits in the west and north walls. Chanting can be heard coming from the west.

The statue depicts Strahd, to whom the cultists made sacrifices in the vain hope that he might reveal his darkest secrets to them. If the characters touch the statue or take the crystal orb from Strahd's hand, five **shadows** form around the statue and attack them. The shadows (the spirits of former cultists) pursue those who flee beyond the room's confines.

The skeletons on the wall are harmless decor.

### CONCEALED DOOR

Characters searching the room for secret doors find a concealed door in the middle of the east wall with a successful DC 10 Wisdom (Perception) check. It's basically an ordinary (albeit rotted) wooden door hidden under a layer of clay. The door pulls open to reveal a stone staircase that climbs 10 feet to a landing (area 32).

### TREASURE

The crystal orb is worth 25 gp. It can be used as an arcane focus but is not magical.

## 32. HIDDEN TRAPDOOR

The staircase ends at a landing with a 6-foot-high ceiling of close-fitting planks with a wooden trapdoor set into it. The trapdoor is bolted shut from this side and can be pushed open to reveal the den (area 3) above.

### DEVELOPMENT

Once the trapdoor has been found and opened, it remains available to characters as a way into and out of the dungeon level.

## 33. CULT LEADERS' DEN

The door in the southwest corner is a **mimic** in disguise. Any creature that touches the door becomes adhered to the creature, whereupon the mimic attacks. The mimic also attacks if its takes any damage.

A chandelier is suspended above a table in the middle of the room. Two high-backed chairs flank the table, which has an empty clay jug and two clay flagons atop it. Iron candlesticks stand in two corners, their candles long since melted away.

## 34. CULT LEADERS' QUARTERS

This room contains a large wood-framed bed with a rotted feather mattress, a wardrobe containing several old robes, a pair of iron candlesticks, and an open crate containing thirty torches and a leather sack with fifteen candles inside it. At the foot of the bed is an unlocked wooden footlocker containing some gear and magic items (see "Treasure" below).

Two **ghasts** (Gustav and Elisabeth Durst) are hidden in cavities behind the earthen walls, marked X on the map; they burst forth and attack if someone removes one or more items from the footlocker. The ghasts wear tattered black robes.

### TREASURE

Characters searching the footlocker find a folded *cloak of protection*, a small wooden coffer (unlocked) containing four *potions of healing*, a chain shirt, a mess kit, a flask of alchemist's fire, a bullseye lantern, a set of thieves' tools, and a spellbook with a yellow leather cover containing the following wizard spells:

1st level: *disguise self*, *identify*, *mage armor*, *magic missile*, *protection from evil and good*

2nd level: *darkvision*, *hold person*, *invisibility*, *magic weapon*

These items were taken from adventurers who were drawn into Barovia, captured, and killed by the cult.

## 35. RELIQUARY

The ghostly chant emanating from area 38 fills this room. Characters can discern a dozen or so voices saying, over and over, "He is the Ancient. He is the Land."

The cult amassed several "relics" that it used in its rituals. These worthless items are stored in thirteen niches along the walls:

- A small, mummified, yellow hand with sharp claws (a goblin's hand) on a loop of rope
- A knife carved from a human bone
- A dagger with a rat's skull set into the pommel
- An 8-inch-diameter varnished orb made from a nothic's eye
- An aspergillum carved from bone
- A folded cloak made from stitched ghoulish skin
- A desiccated frog lashed to a stick (could be mistaken for a *wand of polymorph*)
- A bag full of bat guano
- A hag's severed finger
- A 6-inch-tall wooden figurine of a mummy, its arms crossed over its chest
- An iron pendant adorned with a devil's face
- The shrunken, shriveled head of a halfling
- A small wooden coffer containing a dire wolf's withered tongue

The southernmost tunnel slopes down at a 20-degree angle into murky water and ends at a rusty portcullis (area 37).

## 36. PRISON

The cultists shackled prisoners to the back walls of alcoves here. The prisoners are long gone (their bones litter the floor in area 27), but the rusty shackles remain.

### SECRET DOOR

A secret door in the south wall can be found with a successful DC 15 Wisdom (Perception) check and pulls open to reveal area 38 beyond.

### TREASURE

Hanging on the back wall of the cell marked X on the map is a human skeleton clad in a tattered black robe. The skeleton belongs to a cult member who questioned the cult's blind devotion to Strahd. Characters who search the skeleton find a gold ring (worth 25 gp) on one of its bony fingers.

## 37. PORTCULLIS

This tunnel is blocked by a rusty iron portcullis that can be forcibly lifted with a successful DC 20 Strength (Athletics) check. Otherwise, the portcullis can be raised or lowered by turning a wooden wheel half-embedded in the east wall of area 38. (The wheel is beyond the reach of someone east of the portcullis.) The floor around the portcullis is submerged under 2 feet of murky water.

## 38. RITUAL CHAMBER

The cult used to perform rituals in this sunken room. The chanting heard throughout the dungeon originates here, yet when the characters arrive, the dungeon falls silent as the chanting mysteriously stops.

The chanting stops as you peer into this forty-foot-square room. The smooth masonry walls provide excellent acoustics. Featureless stone pillars support the ceiling, and a breach in the west wall leads to a dark cave heaped with refuse. Murky water covers most of the floor. Stairs lead up to dry stone ledges that hug the walls. In the middle of the room, more stairs rise to form an octagonal dais that also rises above the water. Rusty chains with shackles dangle from the ceiling directly above a stone altar mounted on the dais. The altar is carved with hideous depictions of grasping ghouls and is stained with dry blood.

The water is 2 feet deep. The ledges and central dais are 5 feet high (3 feet higher than the water's surface), and the chamber's ceiling is 16 feet high (11 feet above the dais and ledges). The chains dangling from the ceiling are 8 feet long; the cultists would shackle prisoners to the chains, dangle them above the altar, cut them open with knives, and allow the altar to be bathed in blood.

Half embedded in the east wall is a wooden wheel connected to hidden chains and mechanisms. A character can use an action to turn the wheel, raising or lowering the nearby portcullis (see area 37).

The hole in the west wall leads to a naturally formed alcove. The half-submerged pile of refuse that fills it is a **shambling mound**, which the cultists dubbed Lorghoth the Decayer. It is asleep but awakens if attacked or if the characters summon the cultists but refuse to complete their ritual (see "One Must Die!" below). A character standing next to the mound can discern its true nature with a successful DC 15 Intelligence (Nature) check.

### "ONE MUST DIE!"

If any character climbs to the top of the dais, read:

The chanting rises once more as thirteen dark apparitions appear on the ledges overlooking the room. Each one resembles a black-robed figure holding a torch, but the torch's fire is black and seems to draw light into it. Where you'd expect to see faces are voids.

"One must die!" they chant, over and over. "One must die! One must die!"

The apparitions are harmless figments that can't be damaged, turned, or dispelled.

Characters on the dais when the cultists appear must sacrifice a creature on the altar or face the cult's wrath; characters can ascertain what must be done with a successful DC 11 Intelligence (Religion) or Wisdom (Insight) check. To count as a sacrifice, a creature must die on the altar. The apparitions don't care what kind of creature is sacrificed, and they aren't fooled by illusions.

If the characters make the sacrifice, the cultists fade away, but their tireless chant of "He is the Ancient. He is the Land," echoes again in the dungeon. Strahd is aware

of the sacrifice, and Death House now does nothing to hinder the characters (see "Endings" below).

If the characters leave the dais without making the sacrifice, the cultists' chant changes: "Lorghoth the Decayer, we awaken thee!" This chant rouses the shambling mound and prompts it to attack. It pursues prey beyond the room but won't leave the dungeon. It can move through tunnels without squeezing and completely fills its space. At the start of the shambling mound's first turn, the chant changes again: "The end comes! Death, be praised!" If the shambling mound dies, the chanting stops and the apparitions vanish forever.

## ENDINGS

The mists of Ravenloft continue to surround Death House until the characters stand atop the dais and either appease or defy the cultists. Strahd is satisfied either way, prompting the mists to recede.

### THE CULT IS APPEASED

Death House harbors no ill will toward a party willing to sacrifice a life to appease the cult. Once the sacrifice is made, the characters are free to go. Upon emerging from the house, the characters advance to 3rd level.

### THE CULT IS DENIED

If the characters deny the cult its sacrifice and either destroy the shambling mound or escape from it, Death House attacks them as they try to leave. When they return upstairs, they must roll initiative as they discover several architectural changes:

- All the windows are bricked up; the bricked-up windows and the outer walls are impervious to the party's weapon attacks and damage-dealing spells.
- All the doors are gone, replaced by slashing scythe-blades. A character must succeed on a DC 15 Dexterity (Acrobatics) check to pass through a blade-trapped doorway unscathed. A character who spends 1 minute studying the blades in a particular doorway can try to take advantage of a momentary gap in their repeating movements and make a DC 15 Intelligence check instead. Failing either check, a character takes 2d10 slashing damage but manages to pass through the doorway. Any creature pushed through a doorway must succeed on a DC 15 Dexterity saving throw or take the damage. The blades can't be disarmed.
- Every room that contains a fireplace, an oven, or a stove is filled with poisonous black smoke. The room is heavily obscured, and any creature that starts its turn in the smoke must succeed on a DC 10 Constitution saving throw or take 1d10 poison damage.
- The interior walls become rotted and brittle. Each 5-foot-section has AC 5 and 5 hit points, and can also be destroyed with a successful DC 10 Strength (Athletics) check. Each 5-foot section of wall that's destroyed causes a **swarm of rats** to pour out and attack. The swarm won't leave the house.

Keep track of initiative as the characters make their way through the house. Once they escape, they advance to 3rd level, and the house does no more to harm them.